

Goodwater Creek Then & Now

1967 & 2009

Hwy 22 & Young's Creek: downstream view

1967



2009

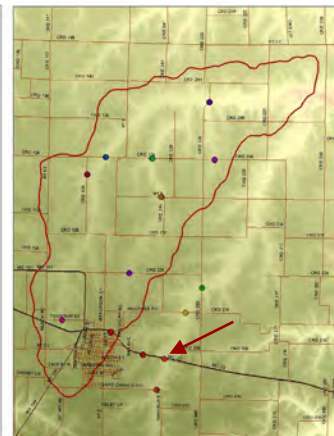

Young's Creek at County Road 906, upstream view

1967



2009

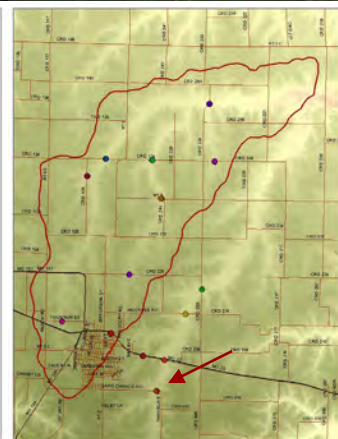

Railroad bridge below Wabash Lake

1967



2009



Tributary crossing Hwy 22 in Centralia

Downstream view

1967



2009



Tributary crossing Hwy 22 in Centralia

Upstream view

1967



2009

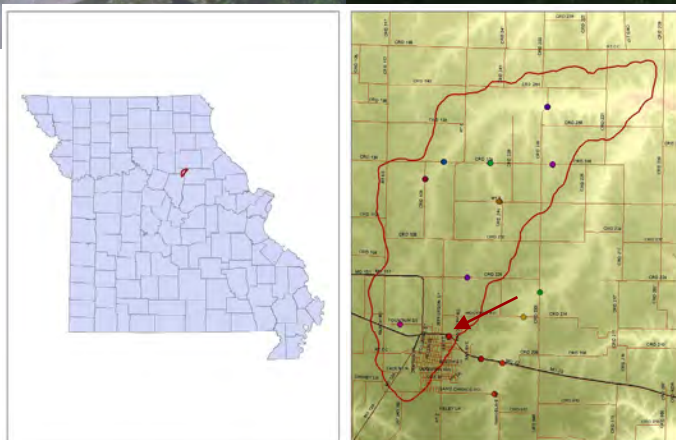

Goodwater Creek at Route 151, downstream from road bridge

1990



2009

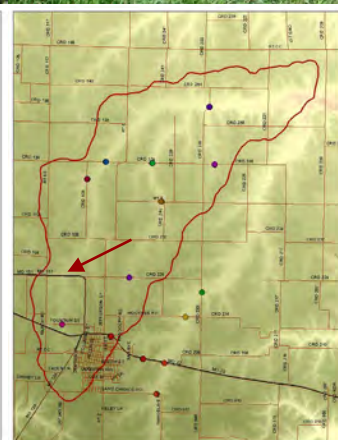

Goodwater Creek at Route 151, upstream from road bridge

March 1977

June 2009

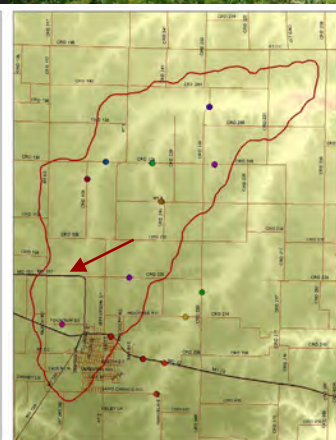

Young's Creek at Co. Road 233, upstream

1967



2009

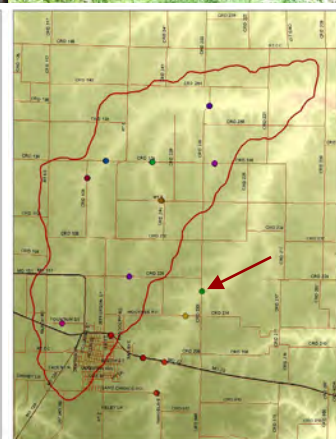

Young's Creek at Co. Road 233 downstream

1967



2009

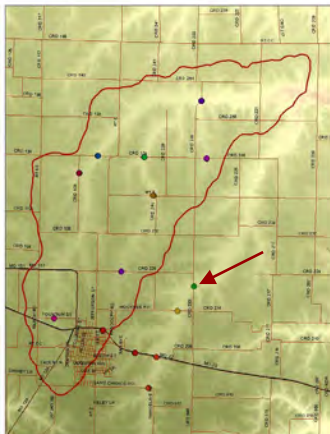
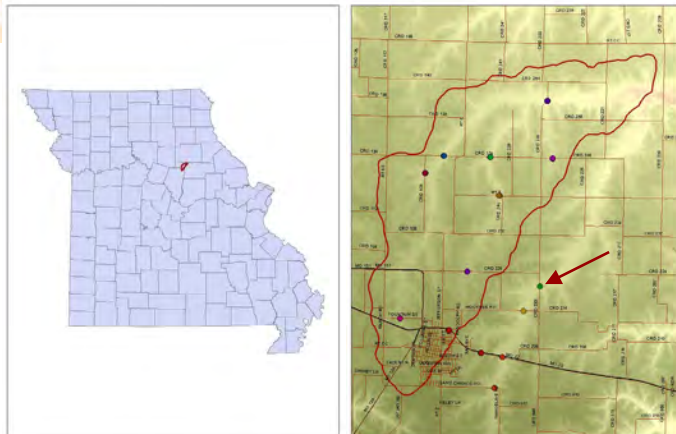

Young's Creek at Co. Road 214, upstream

1967



2009

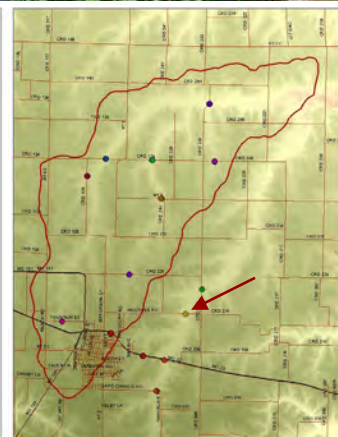

Young's Creek at Co. Road 214, downstream

1967



2009

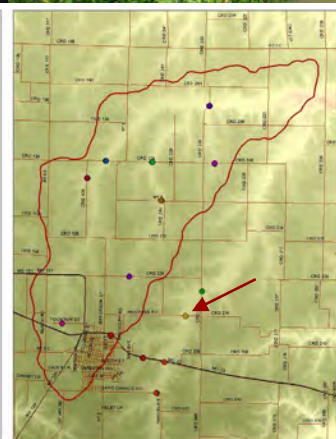

Goodwater Creek at Co. Road 124, downstream

1967



2009

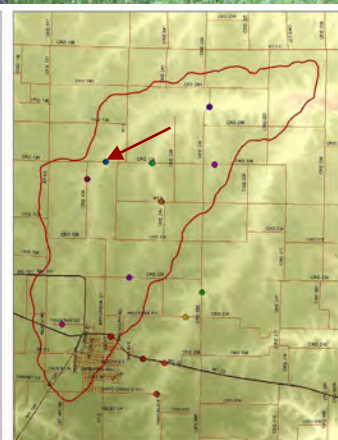

Goodwater Creek unnamed tributary at Route T, upstream from road

1967



2009

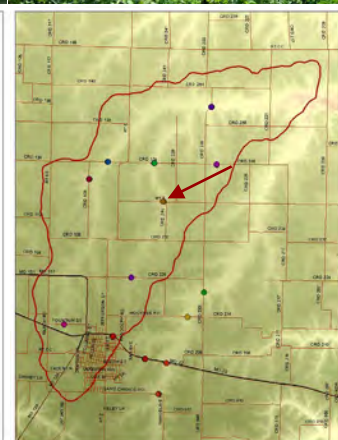

Goodwater Creek unnamed tributary at Route T, downstream from road

1967



2009

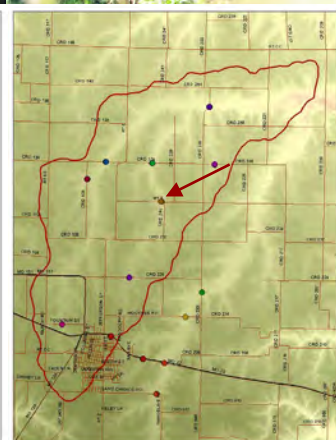

Goodwater Creek at Road 233 upstream from road

1967



2009

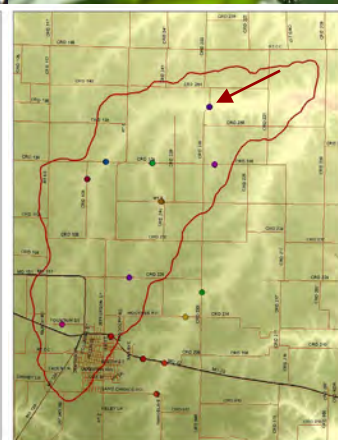
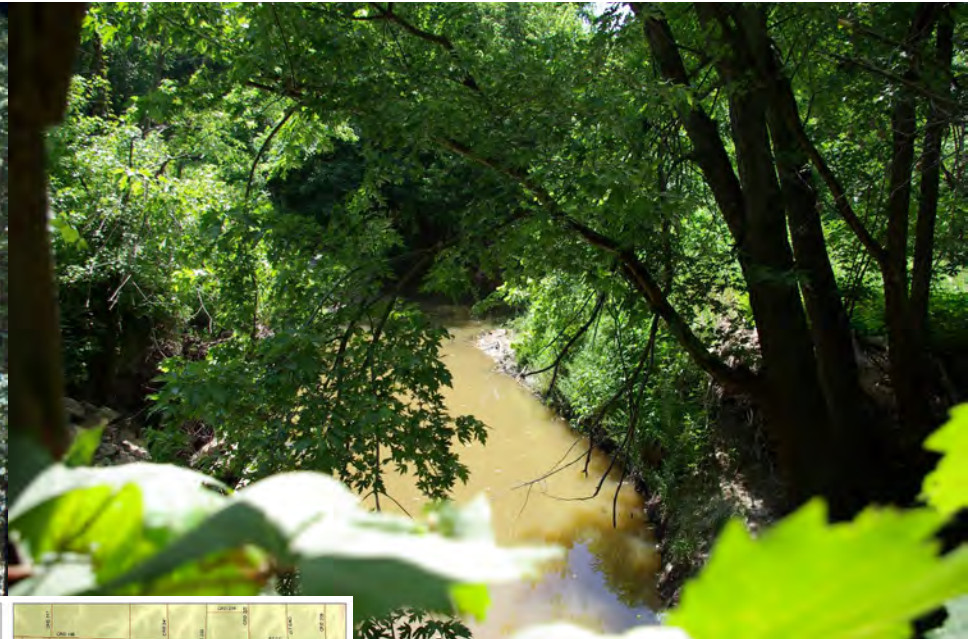

Goodwater Creek at Road 233 downstream from road

1967



2009

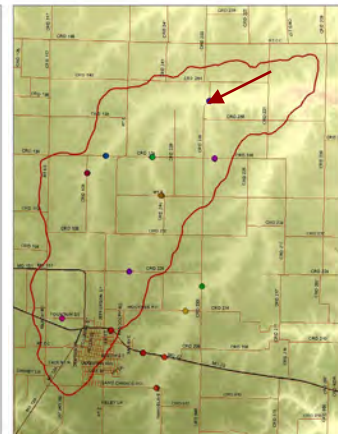

Goodwater Creek at Road 221

View from downstream toward road

1990



2009

